



NJ-87A01

Rear Interlock (Anti-tilt)
130 pound class (60 kgs)



Rear Interlock

» Features » Drawing » Specification Table » Installation Instructions

Product Photo



Features



Mounting | Side mount.
Slide Clearance | 1/2" (12.7 mm) plus 1/32" minus 0 each side.
Height | 54.5 mm
Loading | 130 pound (60 kgs) class (based on single side interlock) .
Size | 16" (400 mm) through 28" (700 mm) in 2" (50 mm) increment.
Feature | Rear interlock mechansim, 32 mm hole pattern, Easy address windows to reach each hole on cabinet member in closed position, Breather tab self adjustment to accommodate variation in side clearance, release trigger for quick drawer removal.
Option | None.

Profile

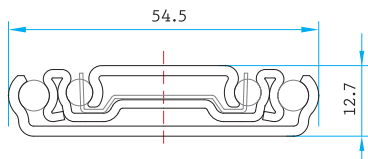

Surface Treatment

- Clear Zinc
- Black E. Coating
- Stainless Steel
- Black Zinc
- White E Coating
- Galvanized Steel

Packaging

- Distribution / 9 pairs per box
- Bulk

*Box QTY might vary with different length, the info provided here is based on 18" (450 mm)

Drawing

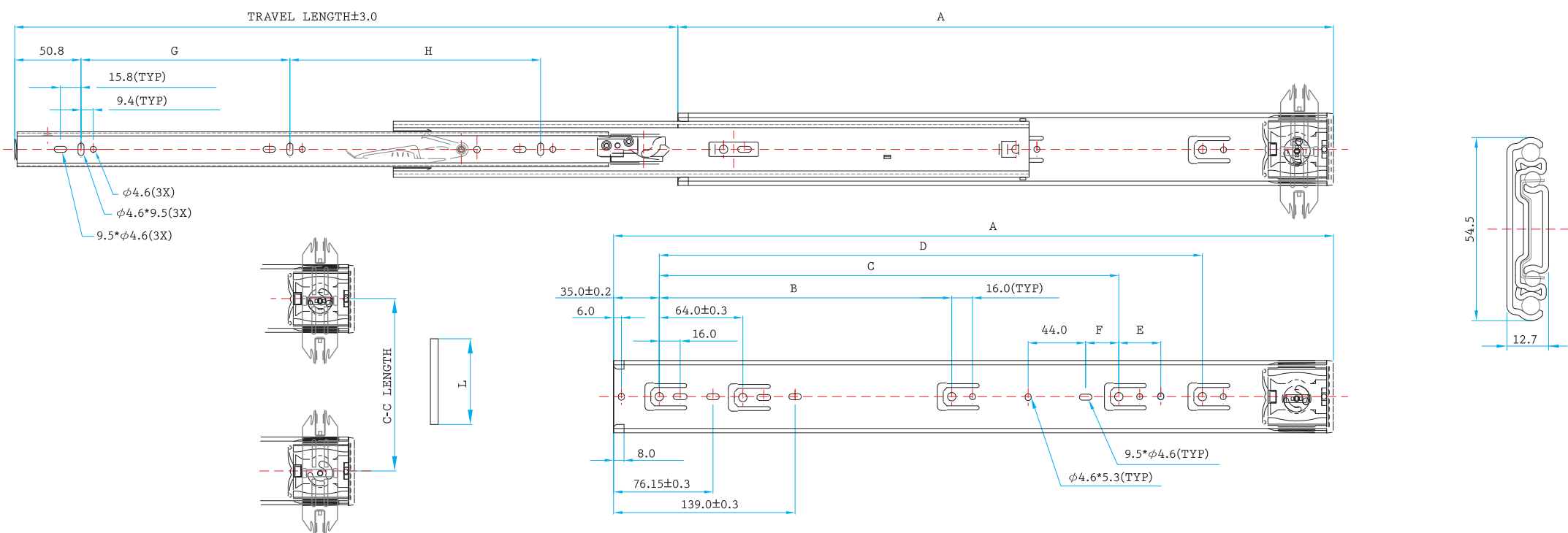

Profile

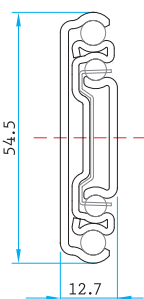

Specification Table

SIZE	TL	A	B	C	D	E	F	G	H
16" (400mm)	406.4	406.4		288.0			25.45	128.0	128.0
18" (450mm)	457.2	457.2	192.0	320.0		32.15	25.45	160.0	160.0
20" (500mm)	508.0	508.0	192.0	320.0	384.0	32.15	25.45	160.0	192.0
22" (550mm)	558.8	558.8	192.0	320.0	416.0	32.15	25.45	192.0	224.0
24" (600mm)	609.6	609.6	224.0	352.0	480.0	32.15	25.45	224.0	256.0
26" (650mm)	660.4	660.4	224.0	384.0	544.0	32.15	25.45	256.0	256.0
28" (700mm)	711.2	711.2	224.0	416.0	576.0	32.15	25.45	288.0	256.0

Installation Instructions

QUICK INSTALLATION GUIDE OF NJ-87A01

Pocket Door Slide, 130 pound (60 kgs) loading



READ THE QUICK INSTALLATION GUIDE FIRST BEFORE INSTALLATION

- A. Recommended screws for fixing – flat head 6 mm euro system screw or #8 pan head screws. Each side of slide requires at least 6 screws
- B. One 4 high vertical file cabinet requires 4 pairs of slides, 3 pieces of connecting rods and 6 tabs*.
Rod length is recommended to be the distance from CL of upper slides to CL of the lower one deduct 70 mm (± 05 mm)

*NJ87A01 is a single side interlock system.

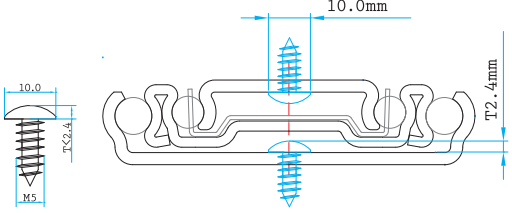

Technical Specifications for drawer

- Drawer must be at least 13.0 mm narrower than cabinet opening on each side (DIM A)
- Bottom of drawer shall have 6.4 mm or 1/4" minimum clearance from the bottom of Cabinet (DIM B)
- Mark a center line with proper height (H)from the bottom of cabinet (DIM C)
- Mark a center line with proper height (H-6.4 mm) from the bottom of drawer (DIM D)

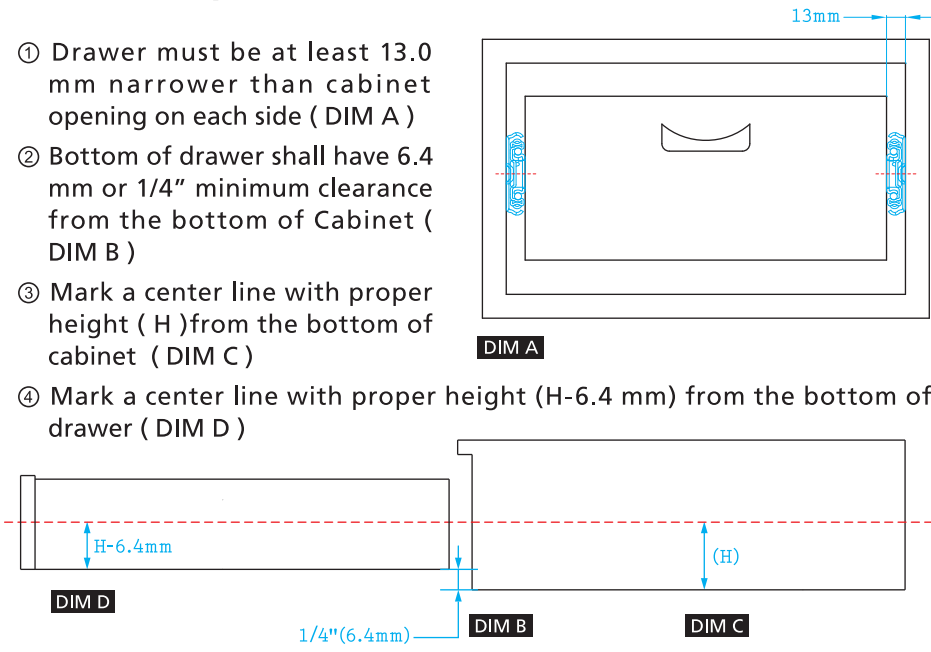

Step 1 > Install Cabinet Member to Cabinet



Push down or lift up release trigger on the right or left to disconnect the drawer member. (Figure2-1)

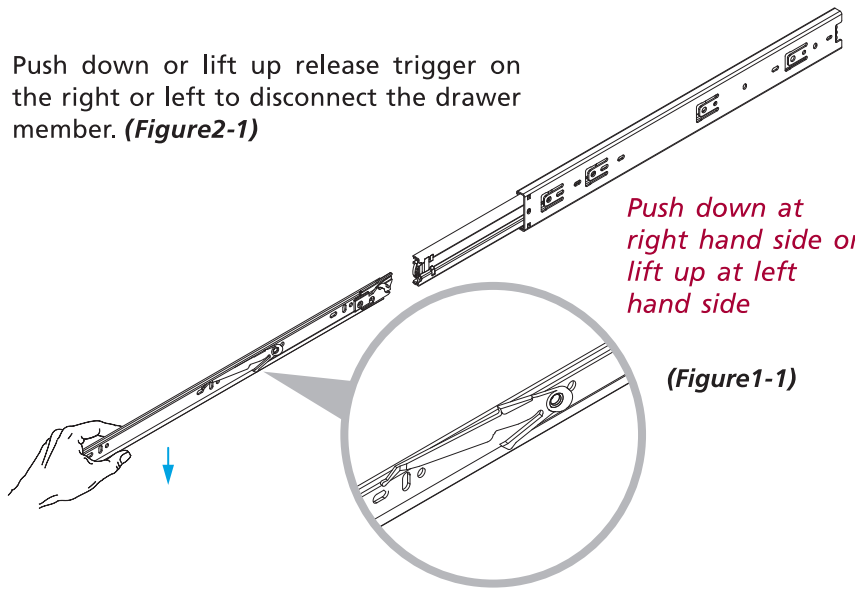

Align center line of cabinet member to pre-determined center line (H), and place slide 2 mm backward from cabinet opening. (Figure2-2)

Use hole on breather tab for side adjustment

Align center of cabinet member to (H) line

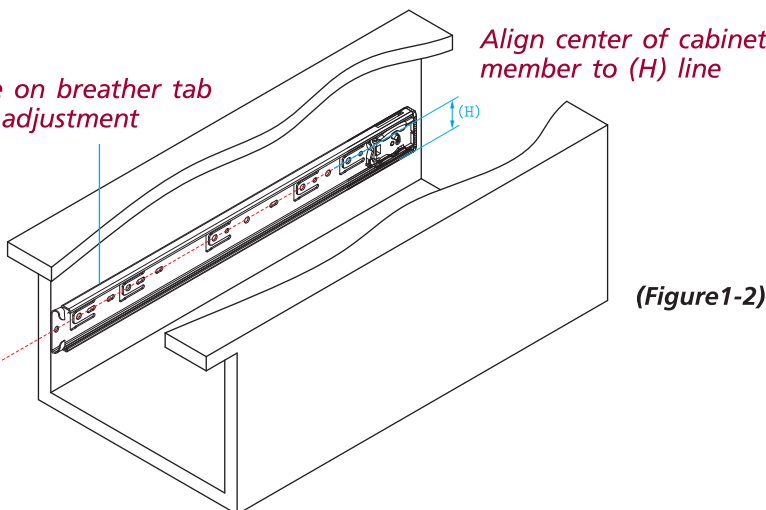

Fix the slides through the most flexible holes on breather tab for best slide performance. Leave the screw loose for final adjustment. Move the slides back and forth, and make sure no screw is bound.

Step 2 > Install connecting rods



Split the tab, and mount upper tab as shown on the following figure 2.



Insert the lower tab into the slot. place rod into the cavity of lower tab, and push upper tab to engage with lower tab.

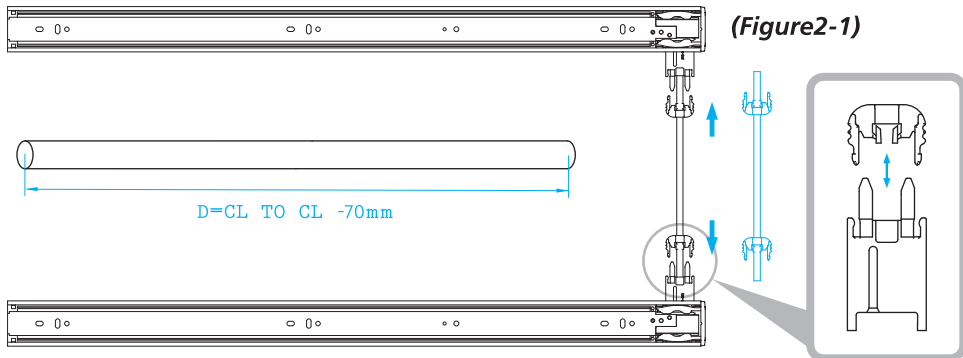

Step 3 > Install Drawer Member to Drawer



Align center line of drawer member to the pre determined line (H-6.4 mm), and place drawer member 2 mm backward from the drawer front or the pulling-out shelf edge. Shall the silencing cushion is used, place drawer member 5.2 mm backward. (Figure3)

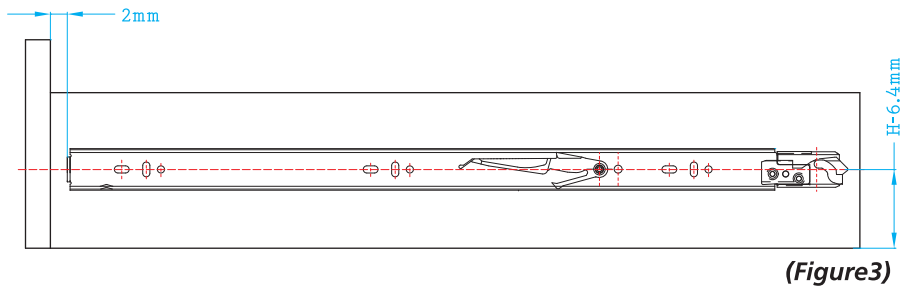

Fix the drawer member through vertical slots for vertical adjustment. Leave the screw loose for final adjustment.

Step 4 > Insert drawer into cabinet



Make sure the bearing retainers are fully forward. Insert drawer member into the cabinet member, and then close the drawer completely. (Figure3-1)

Final Adjustment.....

Try to open and close the drawer to see if slides function correctly. If so, secure the screws and install additional screws as necessary. If not, please make adjustment till slides function correctly.

*This instruction is for reference only. It may vary due to different applications.

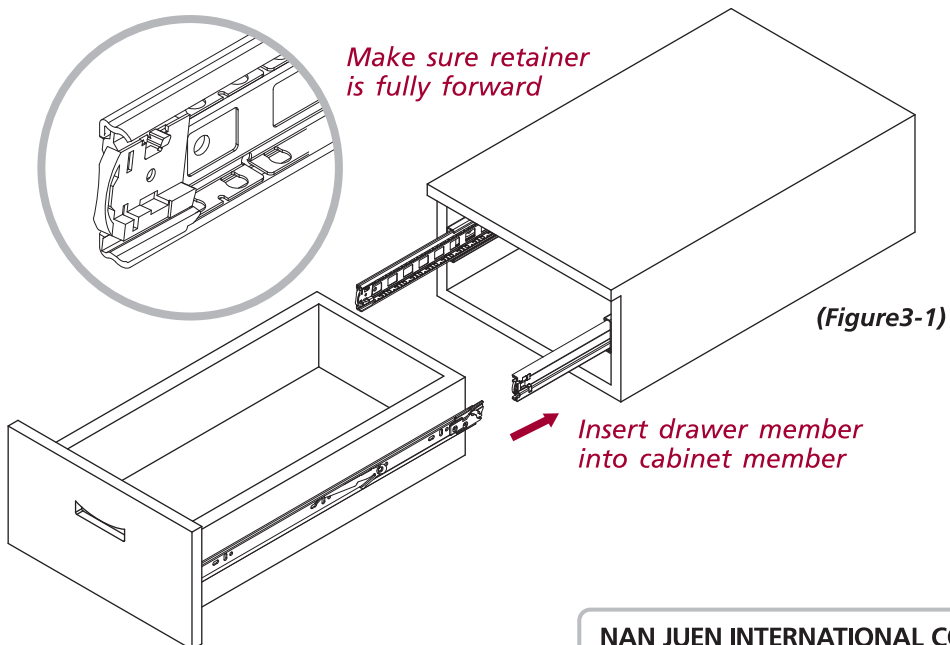

NAN JIEN INTERNATIONAL CO., LTD.
No.2, Dazhi Rd., Taoyuan Dist., Taoyuan City 330, Taiwan (R.O.C.)
T + 886 - 3 - 3642777(Rep.) F + 886 - 3 - 3762777
www.repongroupp.com

