



NJ-41K08

Under Counter Slides
75 pound class (35 kgs)



Under Counter

» Features » Drawing » Specification Table » Installation Instructions

Product Photo



Features



Mounting | Slide mount of drawer members, under the surface for cabinet member.

Slide Clearance | 1/2" (12.7 mm)+1/16"

Height | Overall heights is adjustable from 55.99 mm to 90.04 mm.

Loading | 75 pound (35 kgs) class.

Size | 300 mm through 700 mm at 50 mm increment.

Feature | 32 mm hole pattern, quick-release trigger for easy drawer removal, hold open, height adjustable brackets for both outboard, inboard applications and anti-rebound bumpers.

Option | None.

Profile

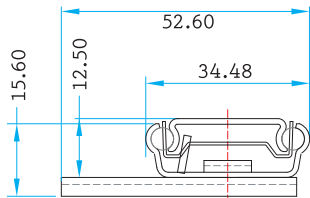

Surface Treatment

- Clear Zinc
- Black Zinc
- Black E. Coating
- White E Coating
- Stainless Steel
- Galvanized Steel

Packaging

- Distribution / 10 pairs per box

*Box QTY might vary with different length, the info provided here is based on 18" (450 mm)

Drawing

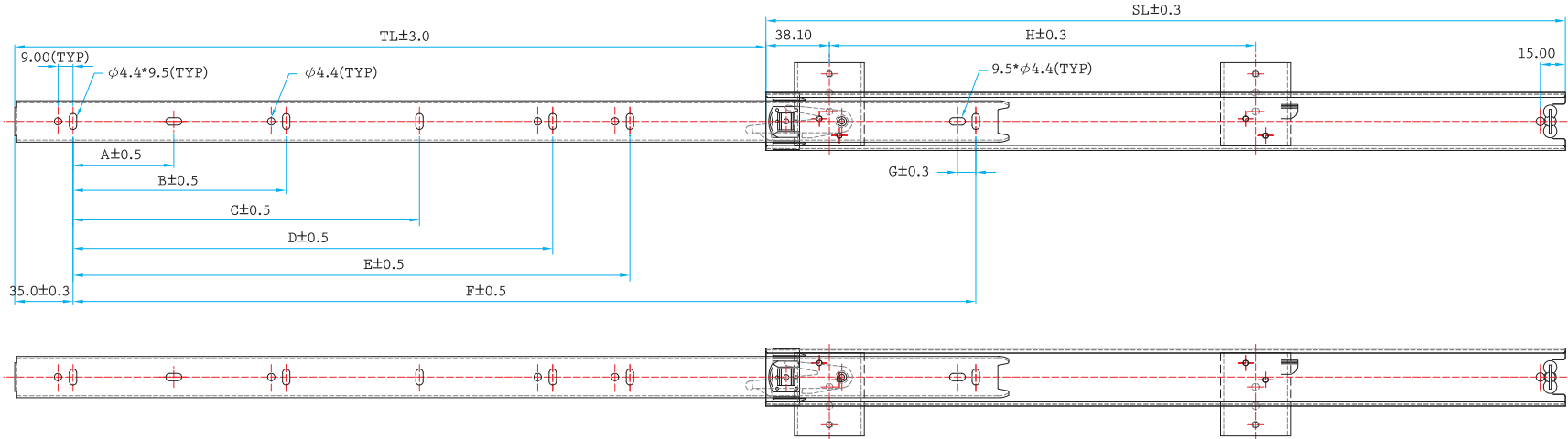

Profile

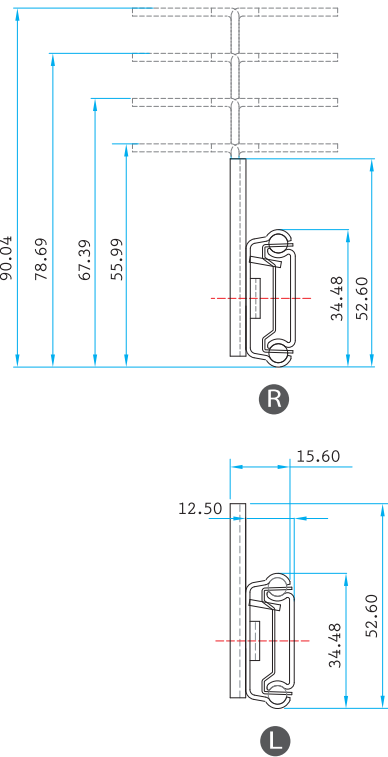

Specification Table

SIZE	SL	TL	A	B	C	D	E	F	G	H
12" (300mm)	300.0	205.0	60.5					242.0	11.0	215.9
14" (350mm)	350.0	260.0	60.5	128.0				242.0	11.0	224.0
16" (400mm)	400.0	281.0	60.5	128.0				342.0	11.0	215.9
18" (450mm)	450.0	331.0	60.5	128.0	192.0			392.0	11.0	215.9
20" (500mm)	500.0	376.0	60.5	128.0	224.0			442.0	11.0	292.1
22" (550mm)	550.0	415.0	60.5	128.0	224.0	288.0		492.0	11.0	292.1
24" (600mm)	600.0	451.0	60.5	128.0	224.0	320.0		542.0	11.0	292.1
26" (650mm)	650.0	488.0	60.5	128.0	224.0	320.0	544.0	542.0	11.0	419.1
28" (700mm)	700.0	526.0	60.5	128.0	224.0	288.0	384.0	642.0	11.0	419.1

Installation Instructions

QUICK INSTALLATION GUIDE OF NJ-41K08

Under Counter Slides, 75 pound (35 kgs) loading



READ THE QUICK INSTALLATION GUIDE FIRST BEFORE INSTALLATION

- Recommended screws for fixing – flat head 6 mm euro system screw or #8 pan head screws. Each side of slide requires at least 7 screws
- Make sure that you have all the slide parts in place. One pair of slides, 4 L shaped brackets and 4 M4 screw (to attach brackets to the slides)

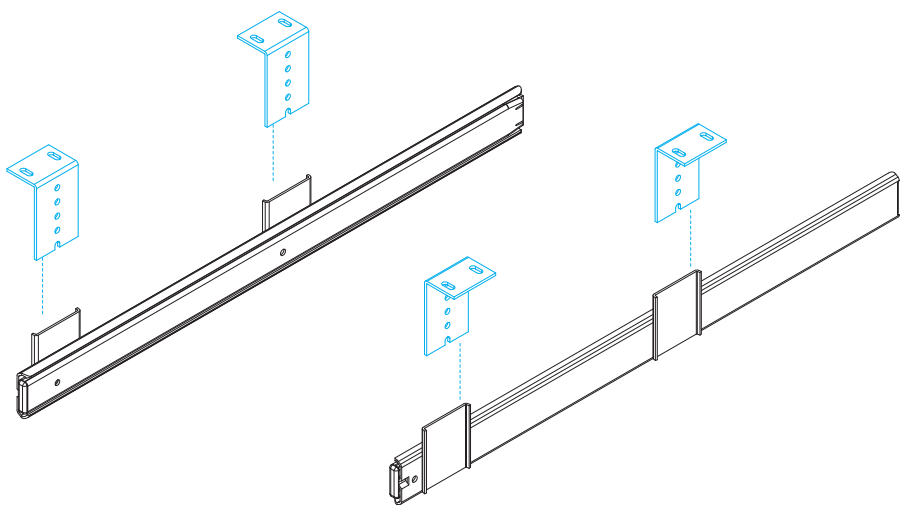
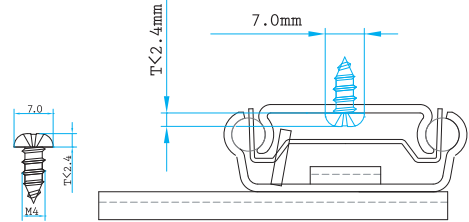

Step 1 > Install drawer member to the keyboard shelf



Press the release latch down (or up) to disconnect the drawer member. **(Figure1-1)**

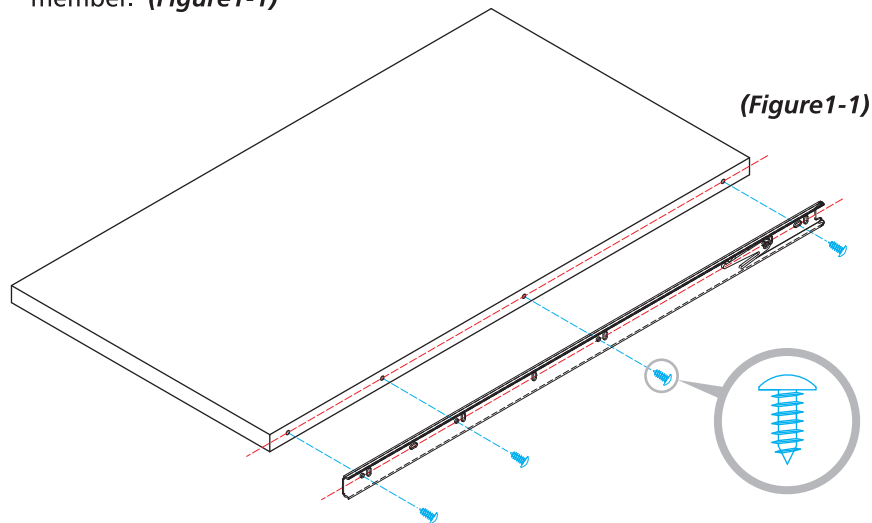

Align the center line of drawer member to the center line of keyboard shelf. **(Figure1-2)**



Affix the slide member with at least 3 #8 screws.

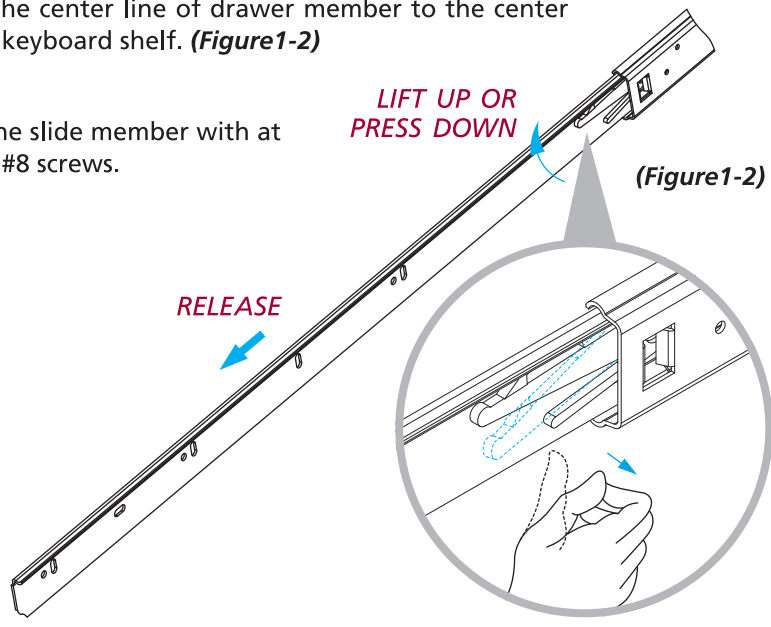

Step 2 > Install cabinet member to the desk bottom



Insert the drawer member mounted shelf into the slide cabinet member in order to determine the location of L shaped brackets. **(Figure2-1)**



Select a preferable L shaped bracket direction (inboard or outboard) and height (62.25 mm~95.85 mm), and secure it onto the cabinet member with M4 screw.



Attach the brackets to the desk bottom and screw them with 2 #8 screws per bracket.

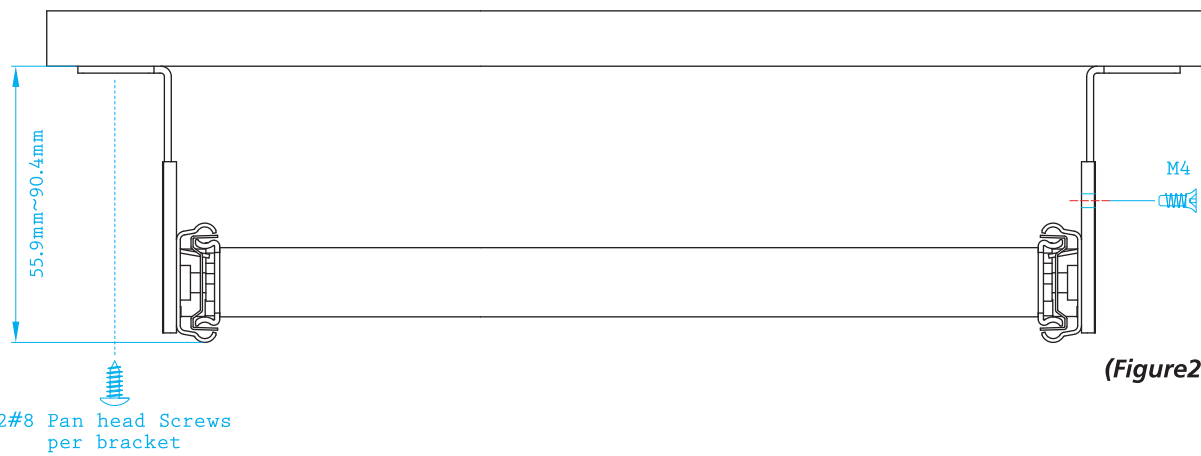

Final Adjustment.....

Try to open and close the drawer to see if lock open and slides function correctly. If so, secure the screws and install additional screws as necessary.

※This instruction is for reference only. It may vary due to different applications.

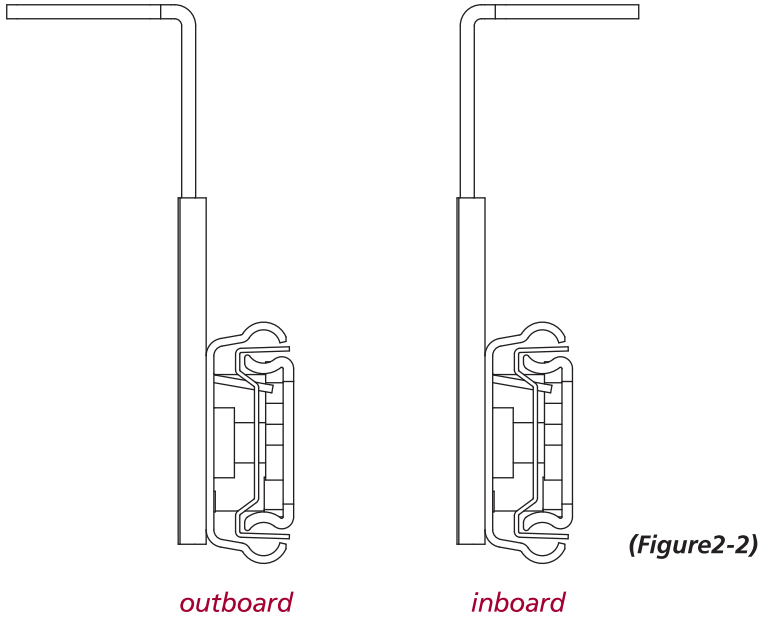

NAN JUEN INTERNATIONAL CO., LTD.
No.2, Dazhi Rd., Taoyuan Dist., Taoyuan City 330, Taiwan (R.O.C.)
T + 886 - 3 - 3642777(Rep.) F + 886 - 3 - 3762777
www.repongroupp.com

