



NJ-21D08

Server Slides (Samurai Plus)

130 pound class (60 kgs)



» Features » Drawing » Specification Table » Installation Instructions

Product Photo



Features



Mounting | Side mount.
Slide Clearance | 10 mm including brackets, maximum chassis width can be 430 mm.
Height | 56 mm
Loading | 130 pound (60 kgs) class for 1000 cycles
Size | 22" (560 mm), 26" (660 mm) .
Feature | Brand new Tool-less bracket design, super low deflection, RoHs complaint zinc plating.
Option | Production pack.

Profile

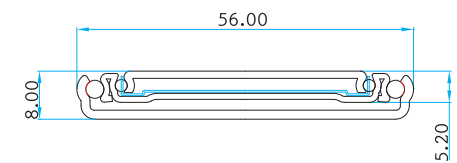

Surface Treatment

- Clear Zinc
- Black Zinc
- Black E. Coating
- White E Coating
- Stainless Steel
- Galvanized Steel

Packaging

- Retail

Drawing

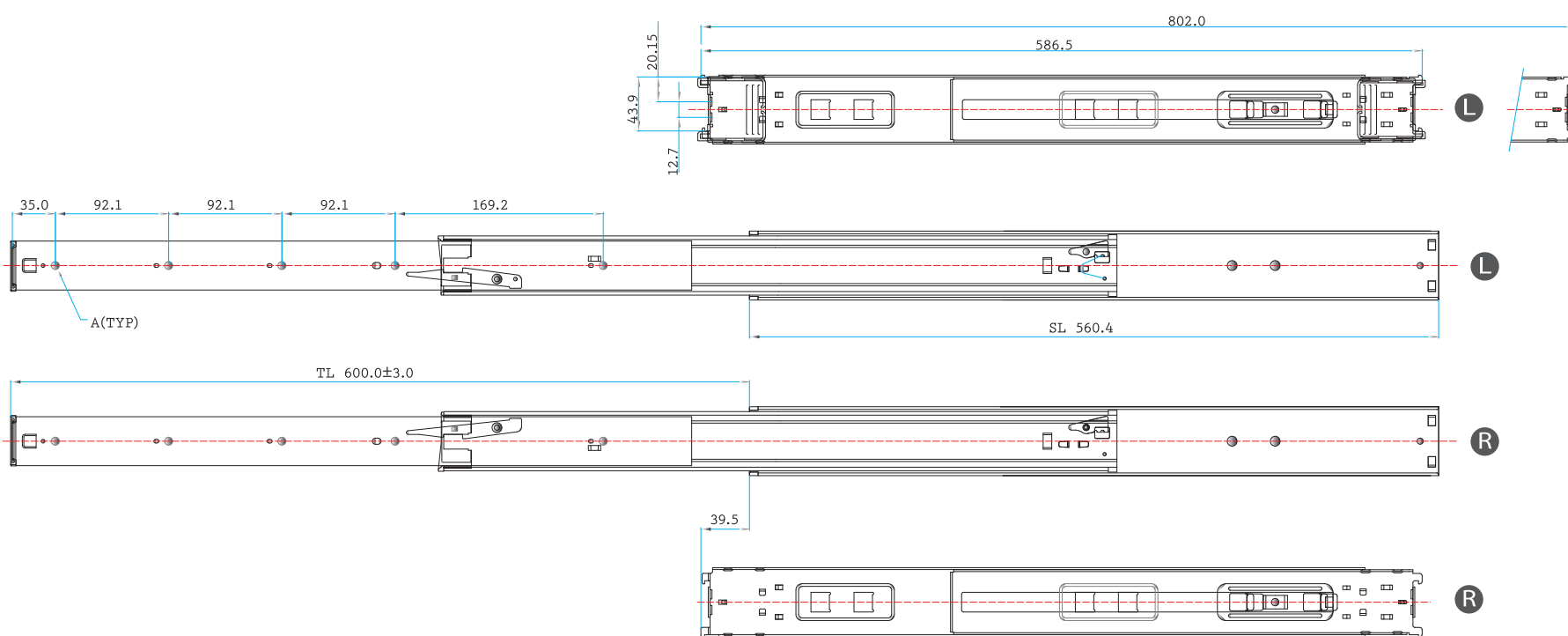

Profile

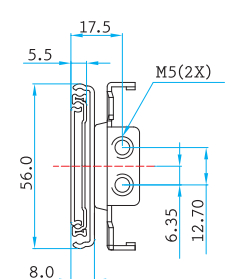

Component Parts

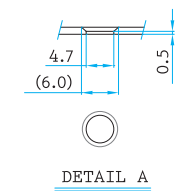

Specification Table

| SIZE | SL | TL | A | B |
|-------------|-------|-------|--------|-------|
| 22" (550mm) | 560.4 | 600.0 | 169.20 | |
| 26" (650mm) | 660.4 | 700.0 | 184.20 | 92.10 |

Installation Instructions

QUICK INSTALLATION GUIDE FOR NJ-21D08 (Tool-less server slides)

Samurai Plus Server Slide, 130 pound (60 kgs) loading
Designed for 3U application or above. Chassis width requirement-430 mm.

PLEASE READ THROUGH THE QUICK INSTALLATION GUIDE BEFORE INSTALLATION

A. Verify if you have every part in place. NJ-21D08 retailing packaging includes 1 pair of slides (1 piece of L hand and 1 piece of R hand), one instruction (QIG) and one screw kit (the kit contains 4 pieces of each M5 and 8 x M4 screws)

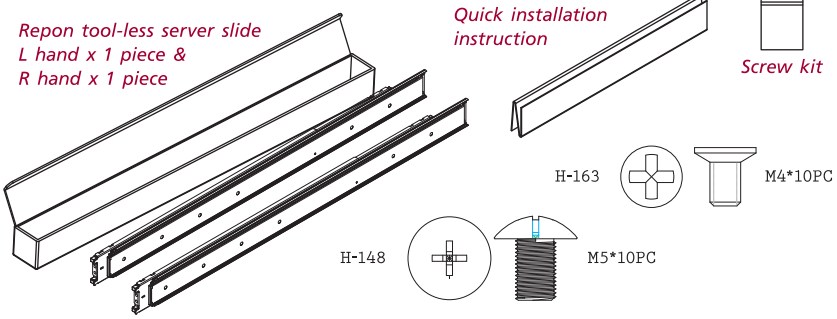

Step 1 > Bracket mounting position & other essential dimensions

NJ21AD08 bracket is designed to take 4 square holes (5/8", 5/8" and 1/2" pitch). (Figure1-1)

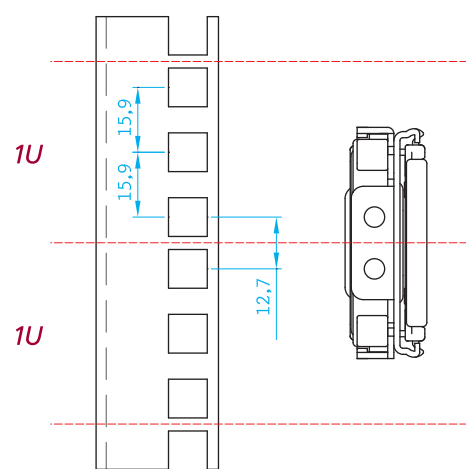

Slide length, travel length and rear bracket extension length. (Figure1-2)

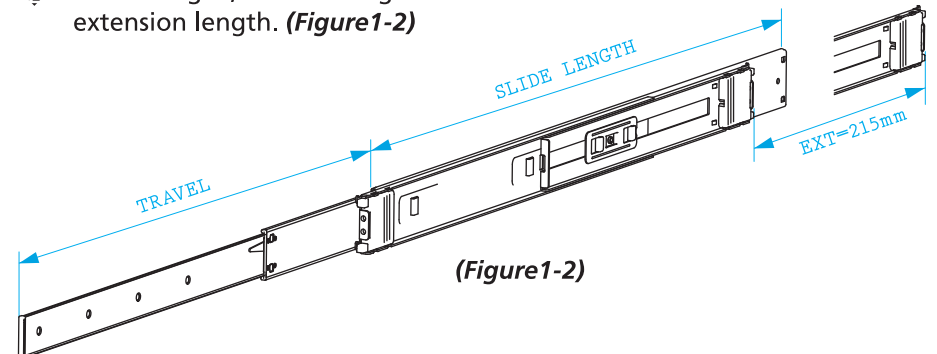

Step 2 > Remove the chassis member from the slide

Removing the chassis member by press the lever down as shown on the following figure. (Figure 2)

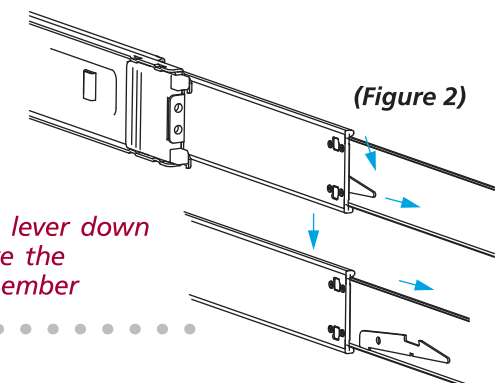

Step 3 > Mount chassis member

Mount chassis member to chassis with M4 screw (4 one each side is recommended) as the following figure. (Figure 3)

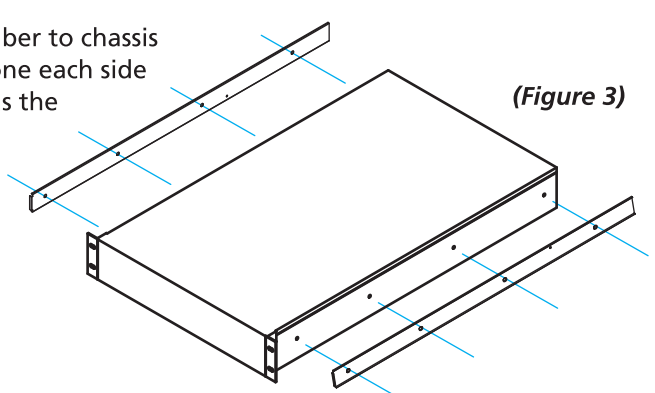

Step 4 > Attach bracket to the rail

Tool-less bracket is designed to mount behind the rail, so insert the barb on bracket into the square hole, and then drop the bracket to allow the plastic insert go through the hole. (Figure2-1)

You may always push the plastic insert backward in order to detach the brackets from rails.

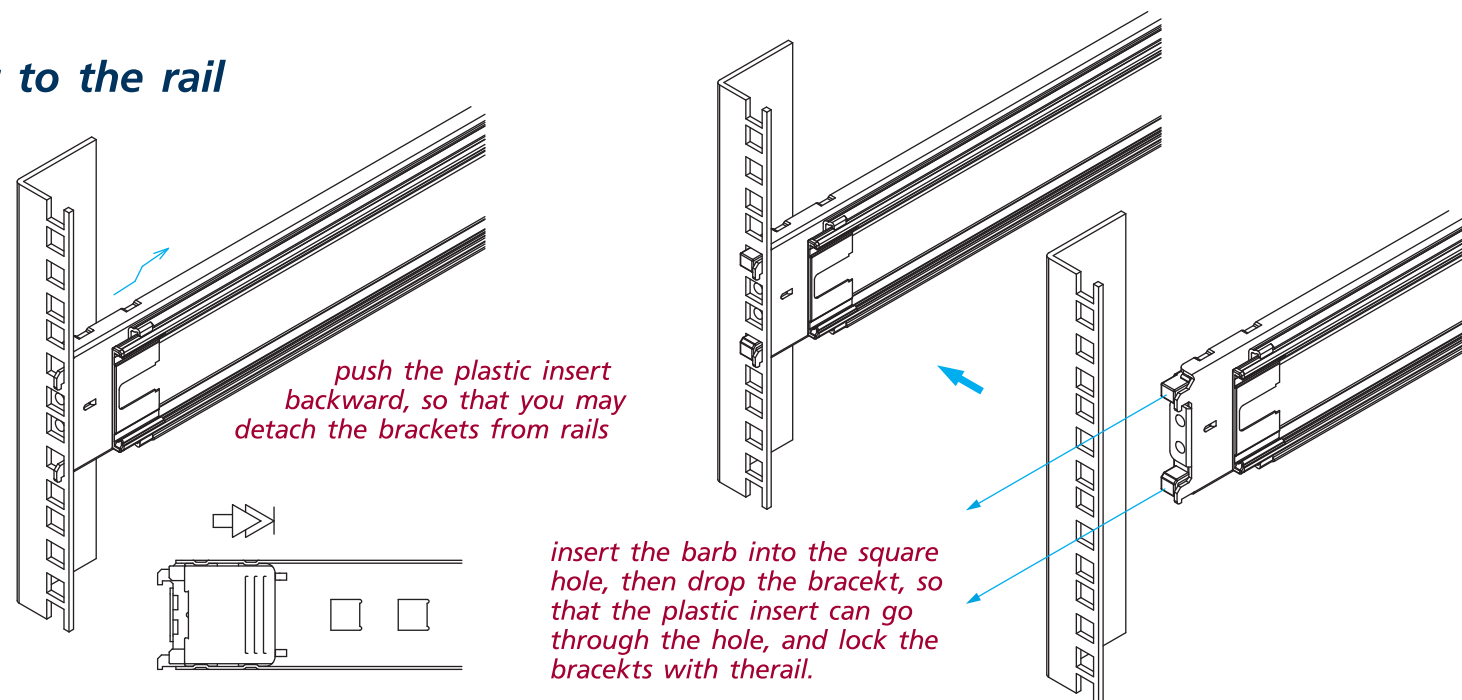

Step 5 > Install chassis

Install chassis by engaging the slide members (insert chassis member into cabinet member). It is important that the ball retainer is in full forward position. (Figure5-1)

You need to release the slide from lock open in initial insertion, then push the chassis all the way back to fully closed position. (Figure5-2)

Open and close the chassis back and forth. If there is any binding or unexpected friction, one of the causes could be bracket misalignment.

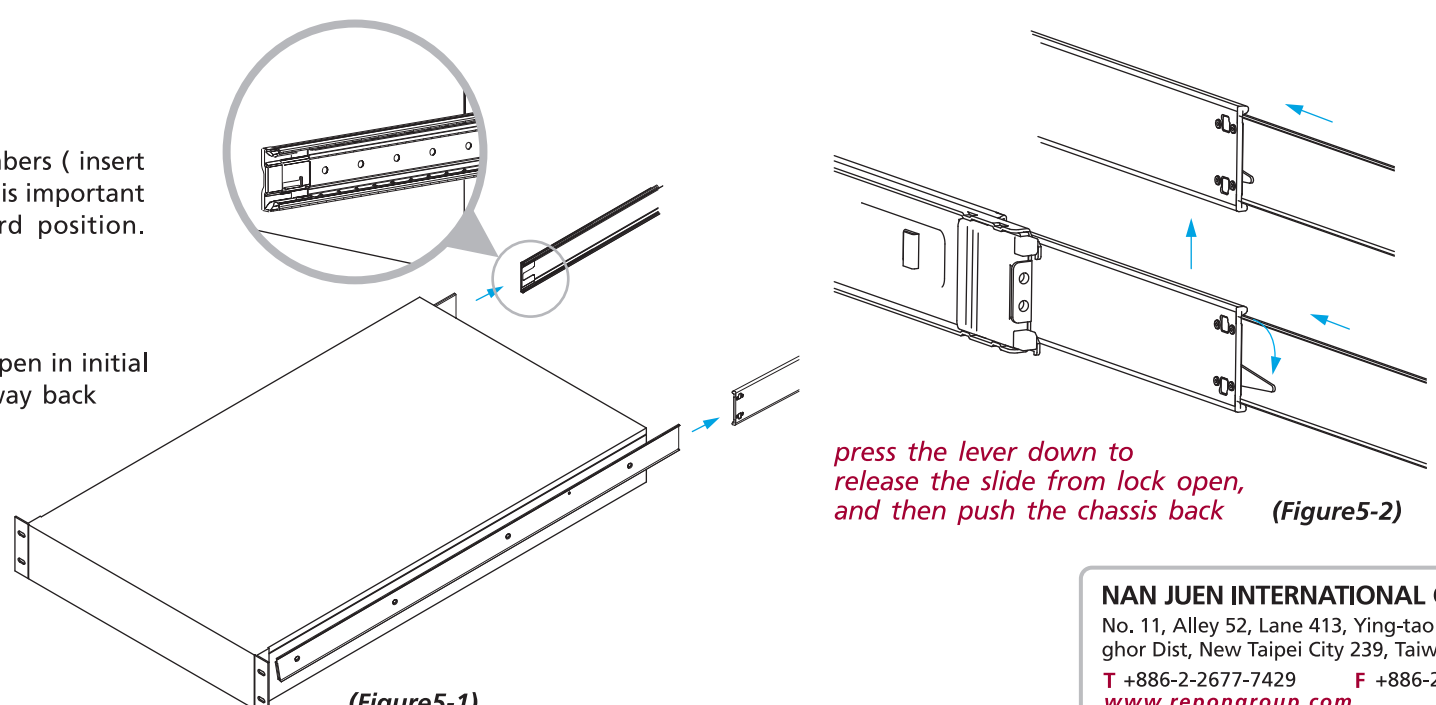

NAN JUEN INTERNATIONAL CO., LTD.
No. 11, Alley 52, Lane 413, Ying-tao Road, Ying-ghor Dist, New Taipei City 239, Taiwan (R.O.C.)
T +886-2-2677-7429 F +886-2-2677-5264
www.repongroupp.com

