



# NJ-21A22

Server Slides (Samurai Tool-less)  
100 pound class (45 kgs)

## Product Photo



## Features



- Mounting** | Side mount.
- Slide Clearance** | 10 mm including brackets, maximum chassis width can be 430 mm.
- Height** | 40.3 mm
- Loading** | 100 pound (45 kgs) class for 1000 cycles.
- Size** | 14"(350 mm) through 28"(700 mm) at 2"(50 mm) increment.
- Feature** | Brand new tool-less bracket design, super low deflection, RoHS complaint zinc plating.
- Option** | Production pack.

## Profile

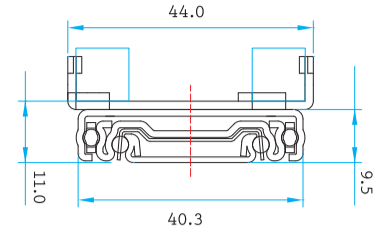

## Surface Treatment

- Clear Zinc
- Black E. Coating
- Stainless Steel
- Black Zinc
- White E Coating
- Galvanized Steel

## Packaging

- Retail
- Distribution / 8 pairs per box

\*Box QTY might vary with different length, the info provided here is based on 18" (450 mm)

## Drawing

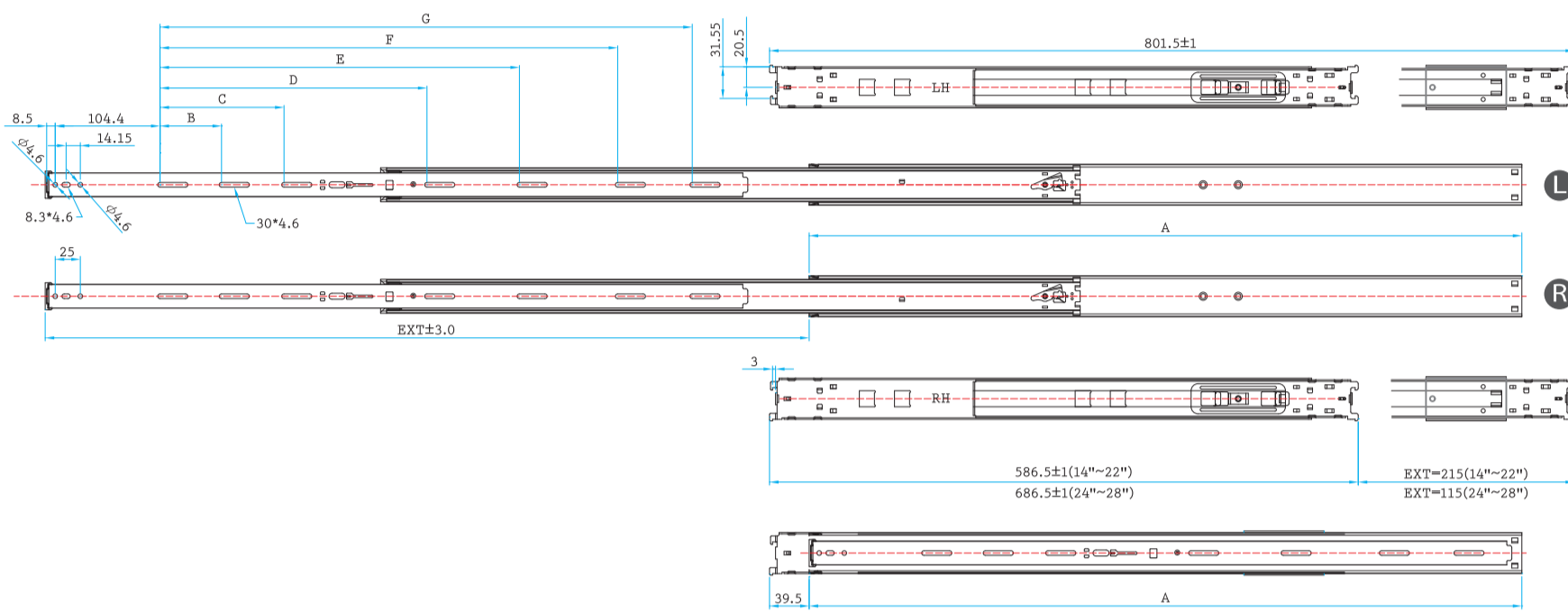

## Profile

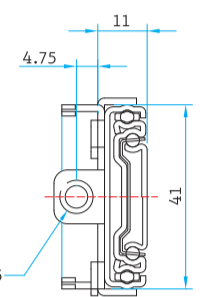

## Specification Table

SIZE	A	B	C	D	E	F	G	EXT
14" (350mm)	360.00		184.2					389
16" (400mm)	410.00		184.2					435
18" (450mm)	460.00		184.2	276.30				487
20" (500mm)	510.00	92.10		276.30				550
22" (550mm)	560.00	92.10		276.30	368.40			600
24" (600mm)	610.00	92.10			368.40			650
26" (650mm)	660.00	92.10			368.40	460.50		700
28" (700mm)	710.00	92.10			368.40	460.50	552.60	750

## Installation Instructions

### QUICK INSTALLATION GUIDE FOR NJ-21A22 (Tool-less server slides)

Samurai Plus Server Slide, 100 pound (45 kgs) loading  
Designed for 1U or 2U application. Chassis width requirement-430mm.

**PLEASE READ THROUGH THE QUICK INSTALLATION GUIDE BEFORE INSTALLATION**

A. Verify if you have every part in place. NJ21A22 retailing packaging includes 1 pair of slides ( 1 piece of L hand and 1 piece of R hand ), one instruction ( QIG ) and one screw kit ( the kit contains 4 pieces of each M5 and 8 x M4 screws )

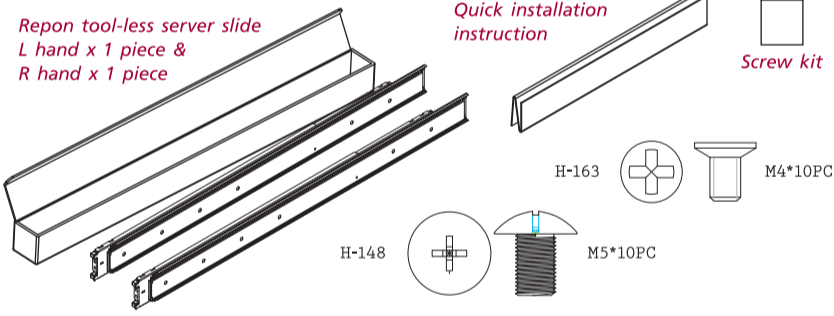

### Step 1 > Bracket mounting position & other essential dimensions

NJ21A22 bracket is designed to fit into 1U hole pattern ( 5/8" & 5/8" pitch ). (Figure1-1)

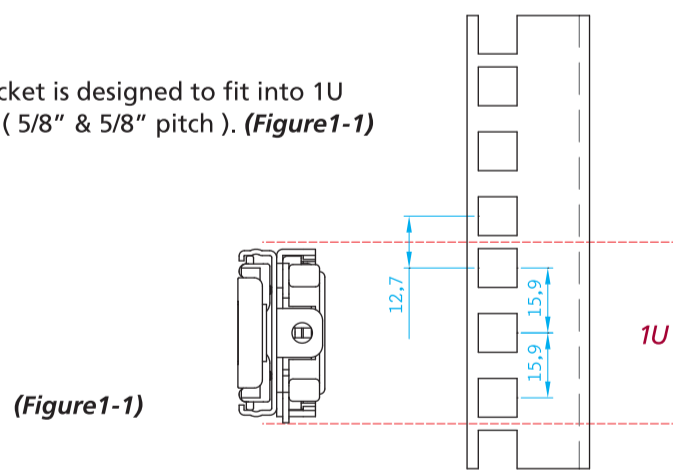

Slide length, travel length and rear bracket extension length. (Figure1-2)

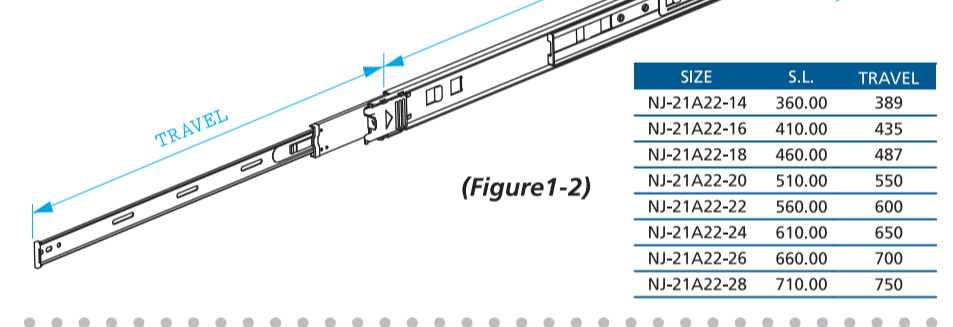

### Step 2 > Remove the chassis member from the slide

Removing the chassis member by pull the green lever outward as shown on the following figure. (Figure 2)



### Step 3 > Mount chassis member

Mount chassis member to chassis with M4 screw ( 4 one each side is recommended ) as the following figure. (Figure 3)

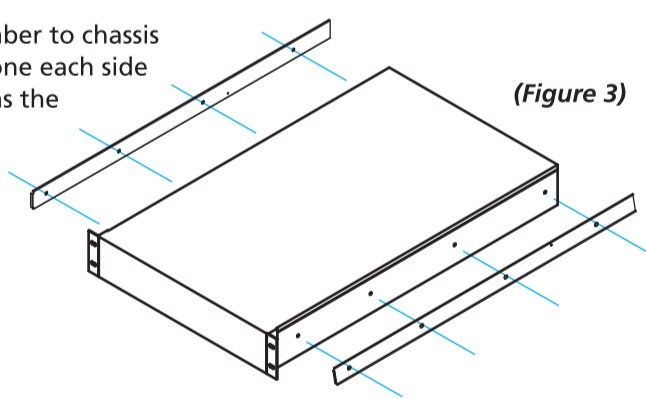

### Step 4 > Attach bracket to the rail

Tool-less bracket is designed to mount behind the rail, so insert the barb on bracket into the square hole, and then drop the bracket to allow the plastic insert go through the hole. (Figure2-1)

You may always push the plastic insert backward in order to detach the brackets from rails.

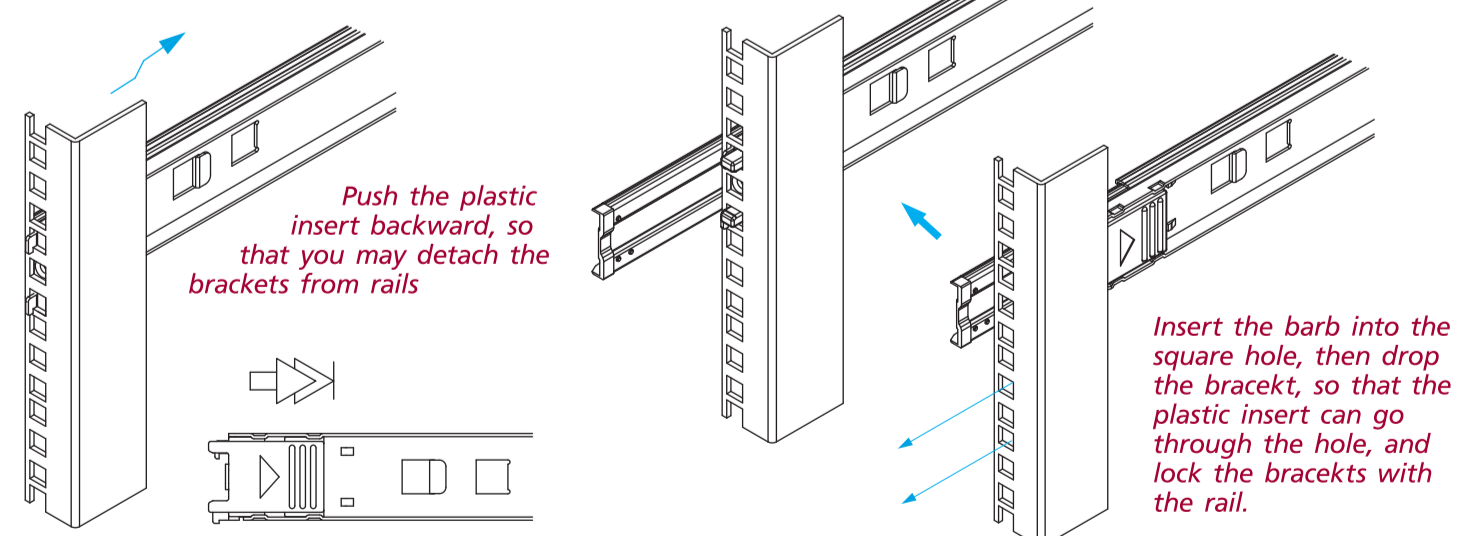

### Step 5 > Install chassis

Install chassis by engaging the slide members ( insert chassis member into cabinet member ). It is important that the ball retainer is in full forward position. (Figure5-1)

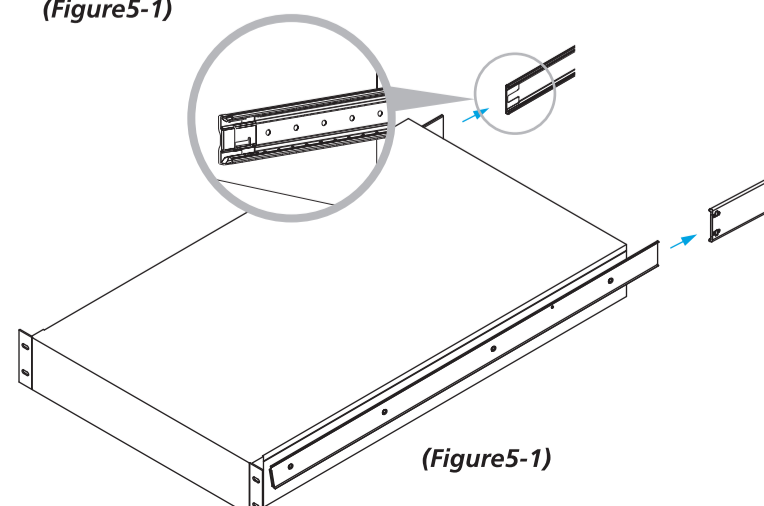

You need to release the slide from lock open in initial insertion, then push the chassis all the way back to fully closed position. (Figure5-2)

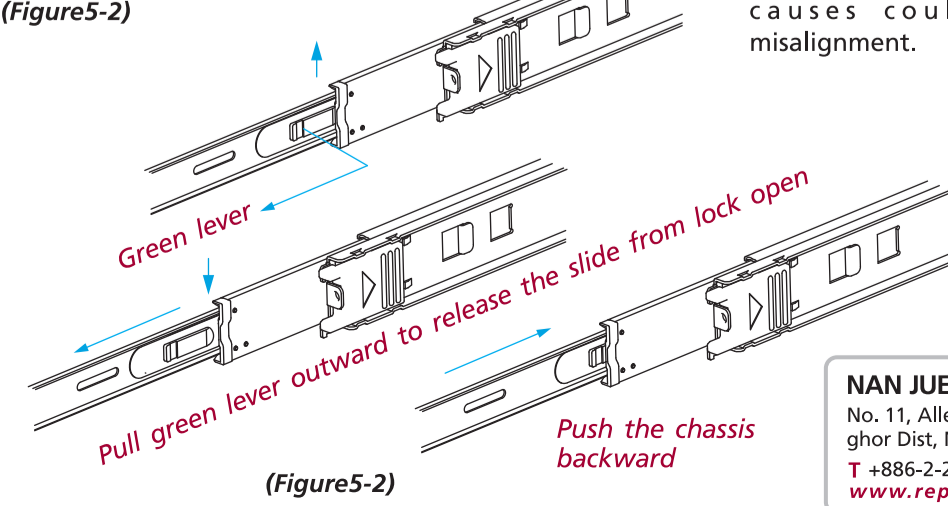

Open and close the chassis back and forth. If there is any binding or unexpected friction, one of the causes could be bracket misalignment.