



NJ-21A05

Server Slides (Samurai Tool-less)
100 pound class (45 kgs)

Product Photo



Features



Mounting | Side mount.
Slide Clearance | 9.5 mm (including brackets), Maximum chassis width can be 430 mm or under.
Height | 40.1 mm
Loading | 100 pound (45 kgs) class for 1000 cycles in 26" (650 mm), static load can be 150 lbs (68 kgs) for 48 hour.
Size | 20" (500 mm) through 28" (700 mm) in 2" (50 mm) increment.
Feature | Behind the rail tool-less bracket design to allow slides to be used in 1U or 2U chassis. Patented front activating lock open/quick release latch, ball retainer stay open device, super low deflection.
Finish | ROHS compliant zinc plated.
Option | None.

Profile

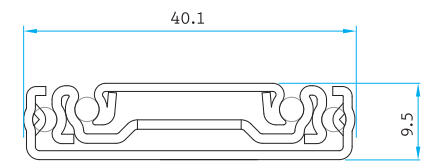

Surface Treatment

- Clear Zinc
- Black E. Coating
- Stainless Steel
- Black Zinc
- White E Coating
- Galvanized Steel

Packaging

- Retail
 - Distribution / 8 pairs per box
- *Box QTY might vary with different length, the info provided here is based on 18" (450 mm)

Drawing

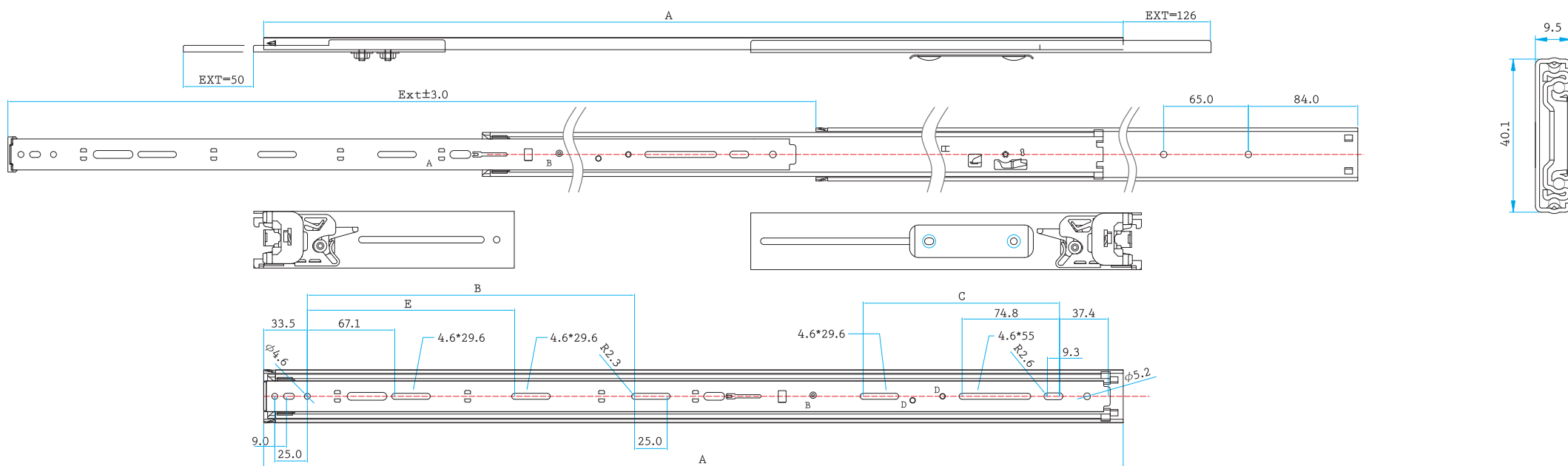

Profile

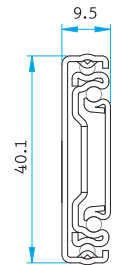

Specification Table

SIZE	EXT	A	B	C	E	F
20" (500mm)	536.0	510.0				178.00
22" (550mm)	587.0	560.0				159.2 179.00
24" (600mm)	636.0	610.0				159.2 201.81
26" (650mm)	687.0	660.0	251.3	150.8	159.2	226.62
28" (700mm)	736.0	710.0	251.3	167.1	159.2	276.62

Installation Instructions

QUICK INSTALLATION GUIDE OF NJ-21A05

Samurai Tool-Less Server Slide, 100 pound (45 kgs) loading

READ THE INSTRUCTION COMPLETELY FIRST BEFORE INSTALLATION

- A. Be sure all components are included in the package.
- 1 piece x LH Samurai Tool-less server slide w / pre-attached Tool-less brackets
 - 1 piece x RH Samurai Tool-less server slide w / pre-attached Tool-less brackets
 - 10 pieces x Philip Keps M4 x 6
 - 2 pieces x Philip M5 x 15

* Restriction and limitation Samureai slides work with the return flange clearance larger than 9.00 mm (Fig 2-1), chassis width equals to or under 430 mm and through holes or window holes.

* Right hand slide must be mounted to the right hand rail, and left hand slide to the left hand rail.

Step 1 > Separate the slide

- Push the green button forward in order to separate the inner member (chassis member) off. (Figure1-1)

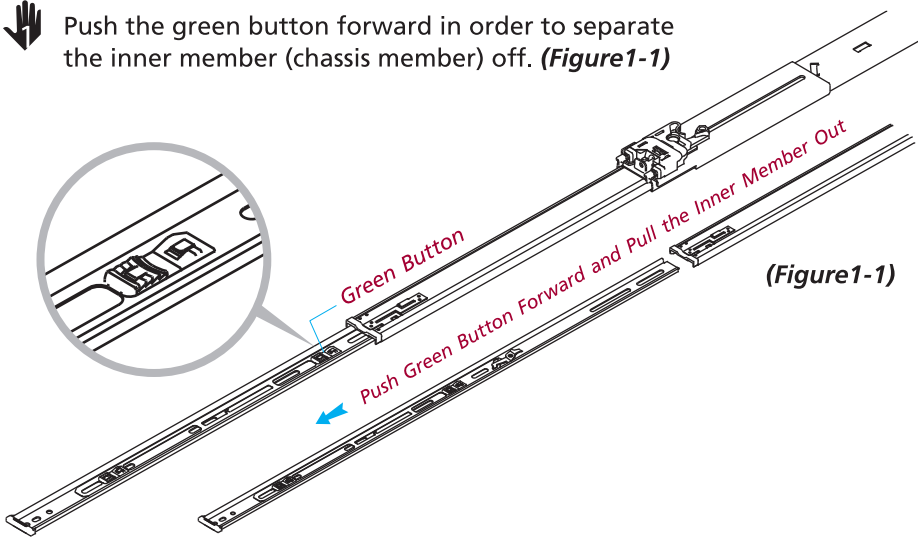

Step 2 > Mount the cabinet member onto the rails

- Align the rear bracket to 5/8" pitch, and have the upper and lower barb go through the hole. (Figure2-1)

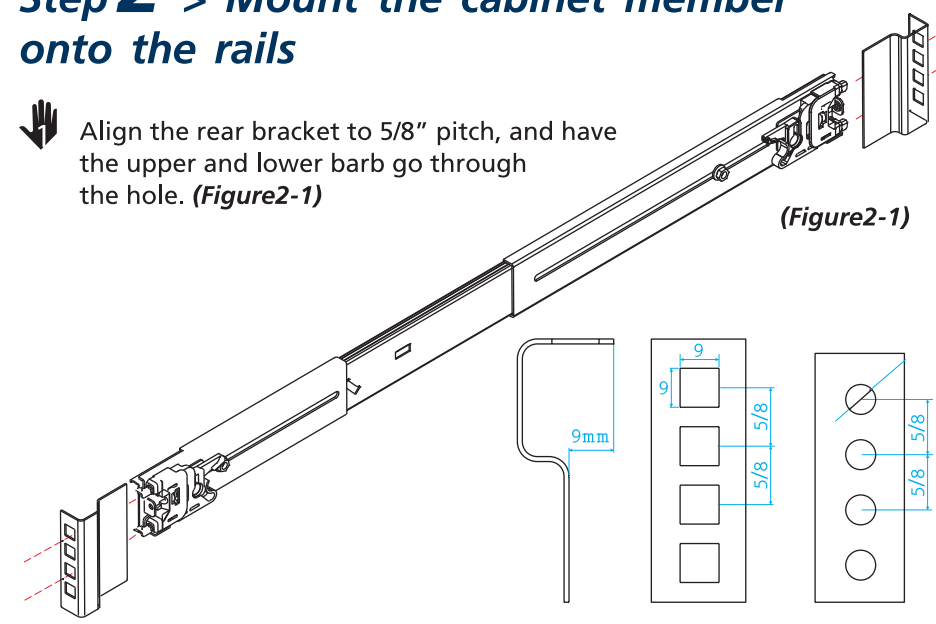

- Drop the rear bracket so that it stays on the rail, and then extend the cabinet member till the front bracket reach the front rail, and barb go through the hole. The maximum rear bracket extension is 125 mm.

- The front bracket can be extended forward by 50 mm to clear the handle plate.

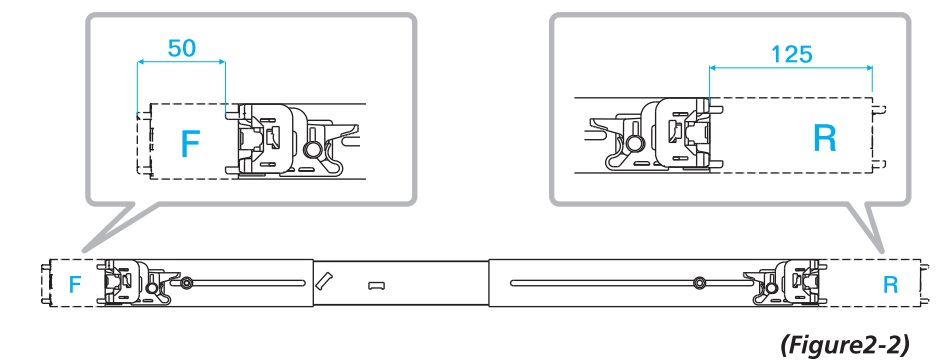

- Lift up the trigger on both front and rear brackets to securely attach the brackets to the rails.

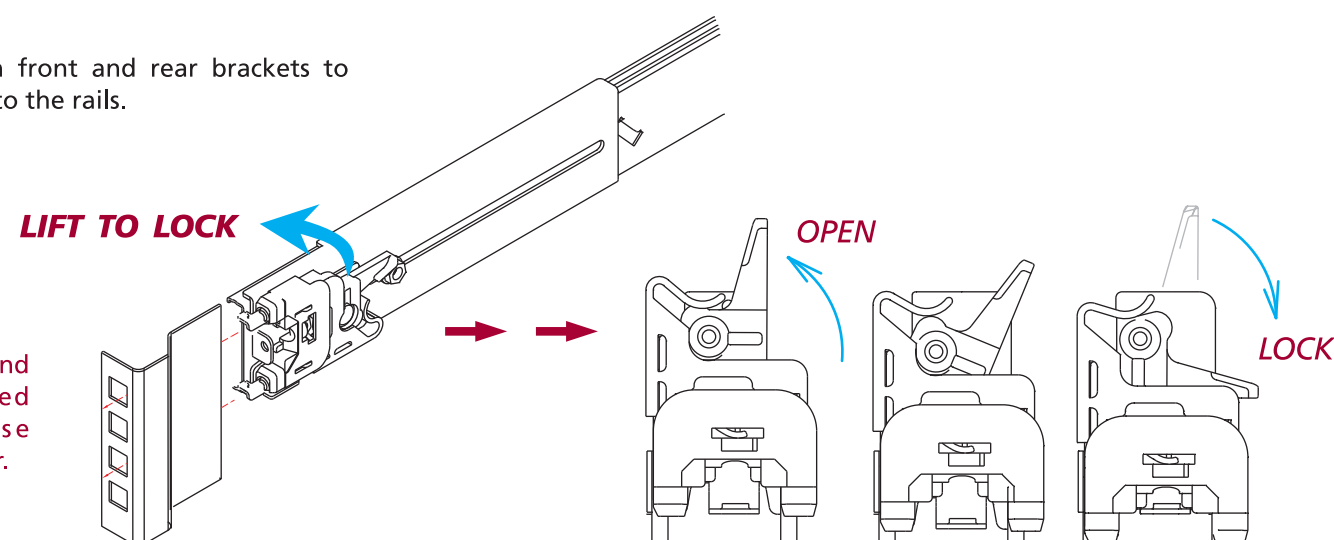

* Trigger must be lifted and pushed to the fully locked position, or might cause catastrophic damage to server.

Step 3 > Insert the chassis into the cabinet

- Affix the chassis member (inner member) to the side of chassis with M4x6 screws. Recommend using at least 3 screws each side. (Figure3-1)
 - Insert the chassis member into the intermediate member of slide.
 - Pull the green button on the front toward the opening to release the slides from lock open. (Figure3-2)
 - Push the chassis all the way back to fully closed position and done!
- * The above reference guide is for reference only. The actual installation might vary due to different applications.
 * Right hand slide must be mounted to the right hand rail, and left hand slide to the left hand rail.

