

⚠ IMPORTANT Before You Start

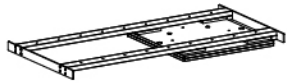

Top pivoting frame assembly x 1



M8 Nut X 8



M8 * 80
Hex countersunk screw
X 8



ST 4.8
countersunk screw
X 12

■ Critical dimension requirements of island and top (cover)

Routing and boring pattern for Island 1200mmx600mm

Boring diameter : 8.5 - 9mm
Quantity of boring hole: 8
Square milling depth : 10mm

Island top (cover) dimension 1200mm x 600mm

Material thickness : 18mm
Top (cover) inner height : 44mm

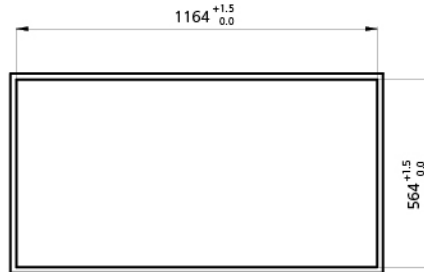
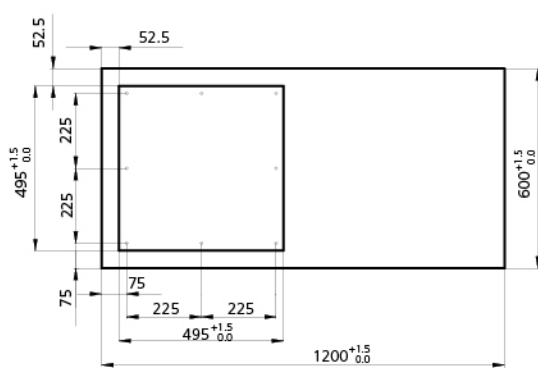

■ Secure the top pivoting frame assembly

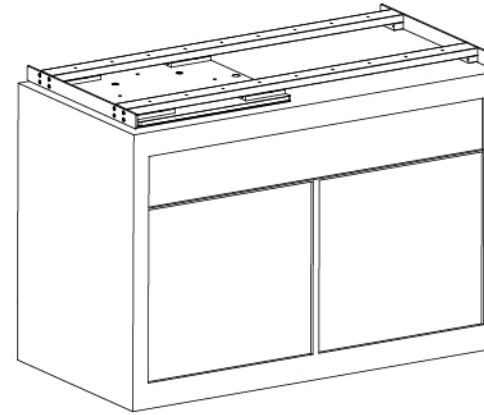

Place the top pivoting frame assembly as shown on figure, and secure with the 2 x M8*80mm hex countersunk screws first.

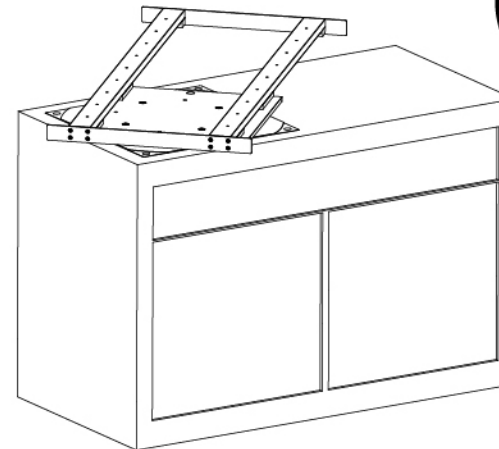
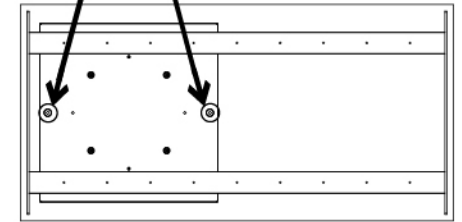

Move the frame clockwise/anti-clockwise to further secure the frame with the 4 x pre-bored holes with M8*80mm hex screws.

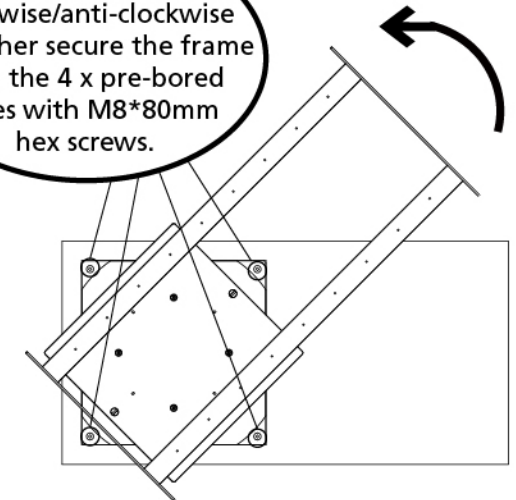

■ Secure the top pivoting frame assembly

Move the frame clockwise/anti-clockwise to 90 degree position to access the remaining 2 pre-bored holes to finish the last step of securing the frame assembly.

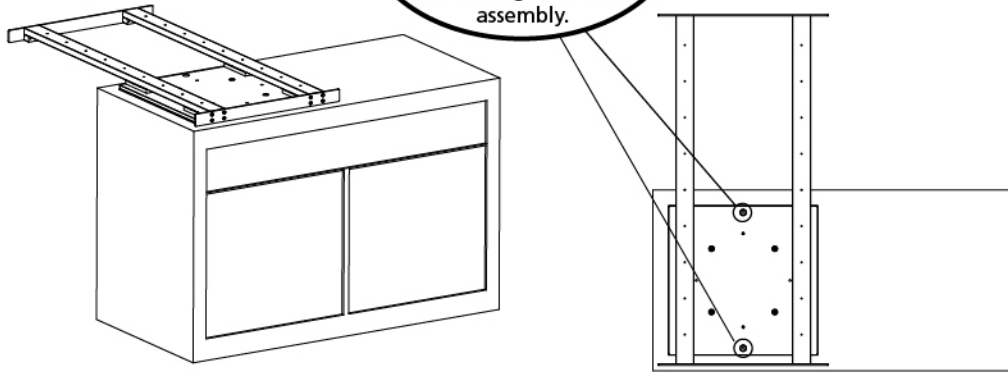

■ Mount the top (cover) onto the frame assembly

Place the top (cover) on frame, and use ST 4.8mm screw to affix the cover to the frame from the bottom of frame. Need to use at least 12 screws, you may secure the cover with more screws at your own discretion.

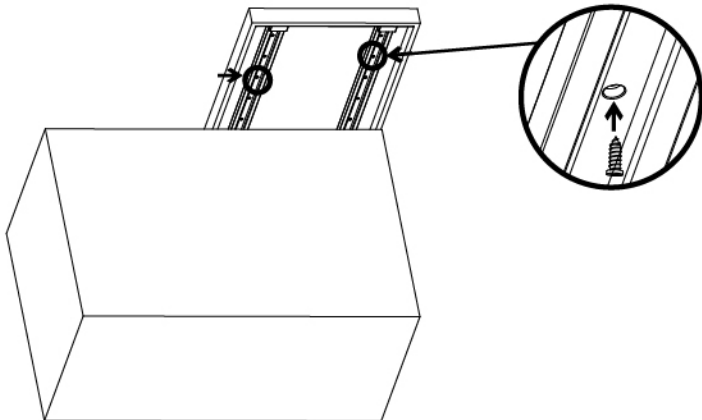

■ Congratulation! Installation is completed.

Move the top around to see if the function of 360 pivot is correct!

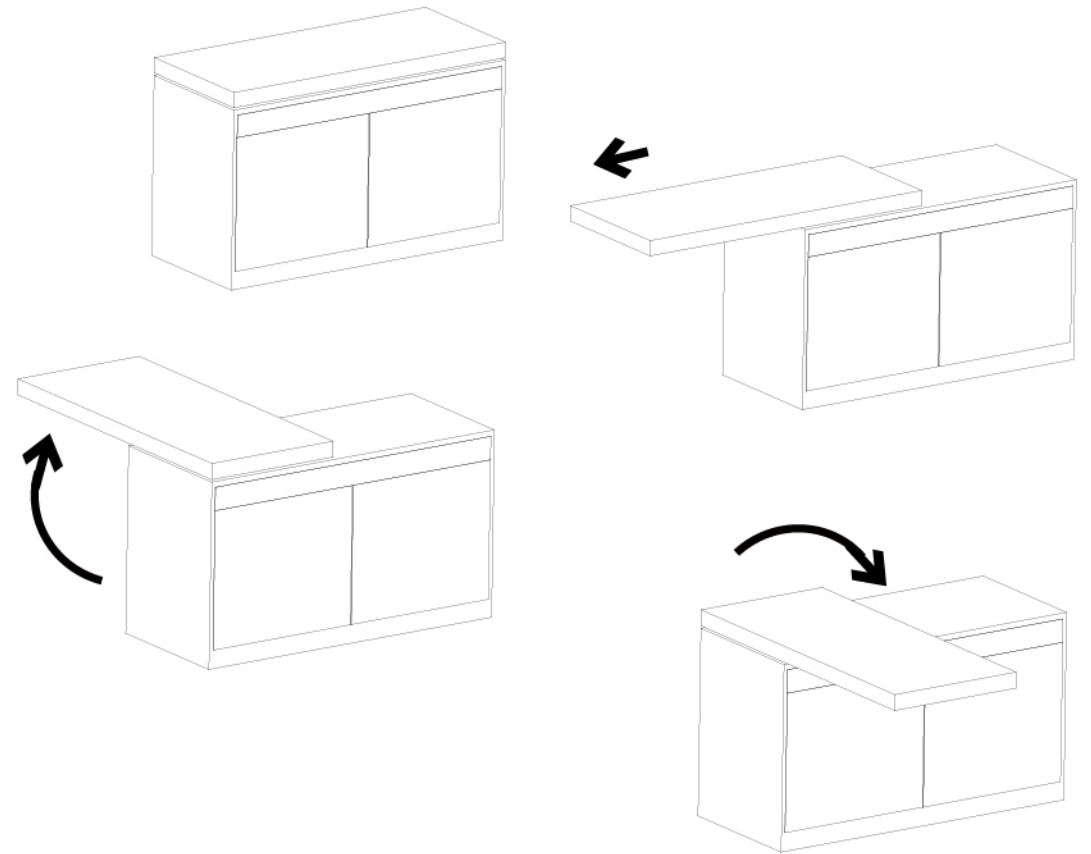

⚠ IMPORTANT Before You Start

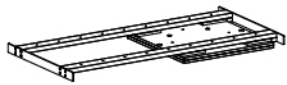

Top pivoting frame assembly x 1



M8 Nut X 8



M8 * 80
Hex countersunk screw
X 8



ST 4.8
countersunk screw
X 12

■ Critical dimension requirements of island and top (cover)

Routing and boring pattern
for Island 1400mmx600mm

Boring diameter : 8.5 - 9mm
Quantity of boring hole: 8
Square milling depth : 10mm

Island top (cover) dimension
1400mm x 600mm

Material thickness : 18mm
Top (cover) inner height : 44mm

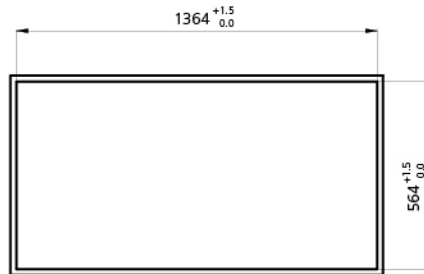
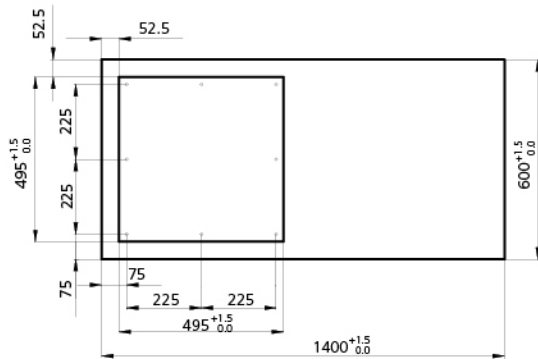

■ Secure the top pivoting frame assembly

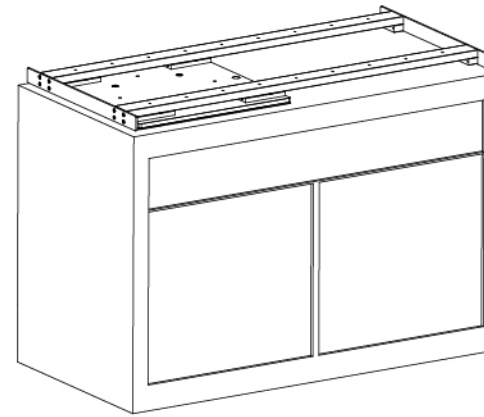

Place the top pivoting frame assembly as shown on figure, and secure with the 2 x M8*80mm hex countersunk screws first.

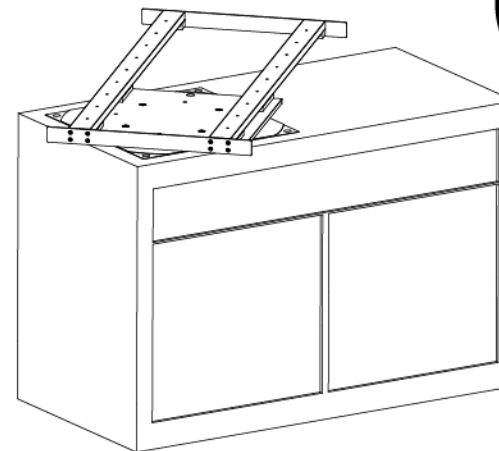
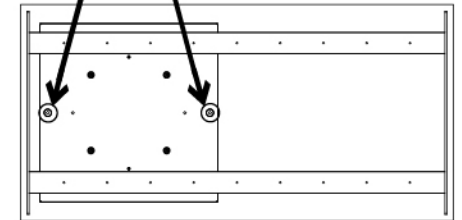

Move the frame clockwise/anti-clockwise to further secure the frame with the 4 x pre-bored holes with M8*80mm hex screws.

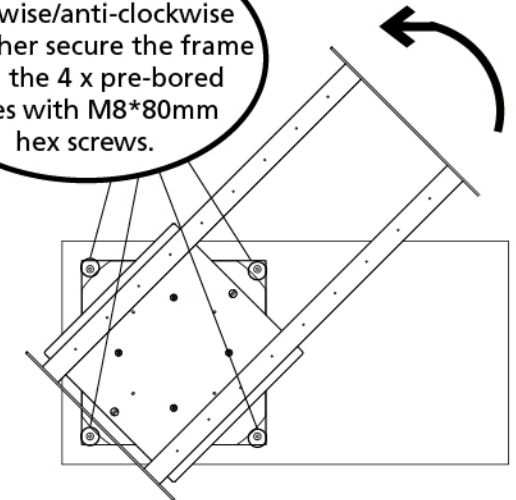

■ Secure the top pivoting frame assembly

Move the frame clockwise/anti-clockwise to 90 degree position to access the remaining 2 pre-bored holes to finish the last step of securing the frame assembly.

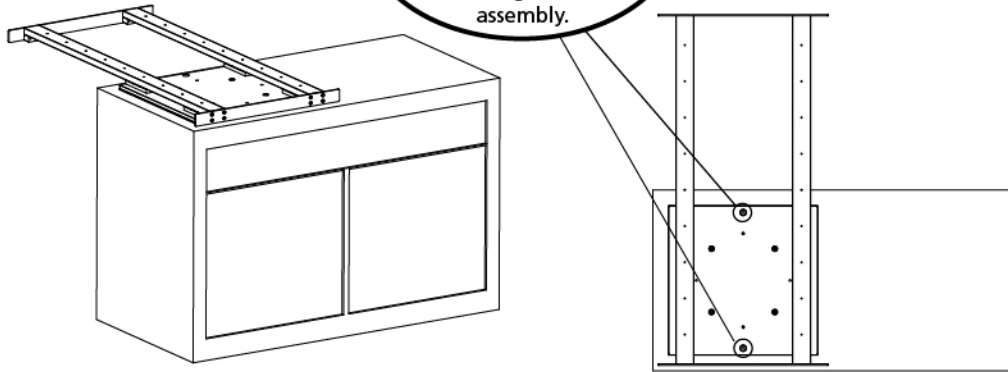

■ Mount the top (cover) onto the frame assembly

Place the top (cover) on frame, and use ST 4.8mm screw to affix the cover to the frame from the bottom of frame. Need to use at least 12 screws, you may secure the cover with more screws at your own discretion.

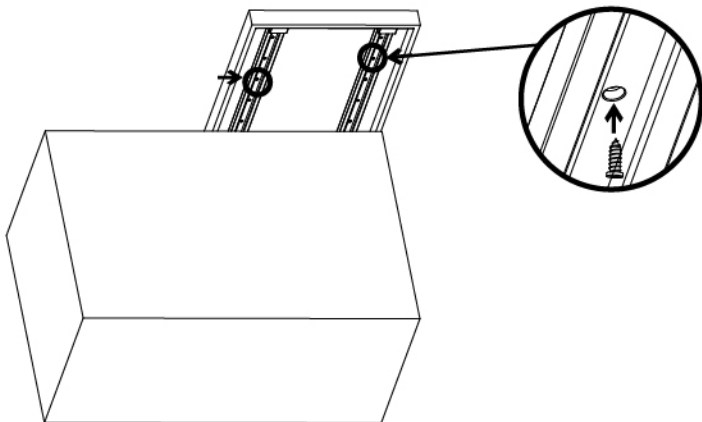

■ Congratulation! Installation is completed.

Move the top around to see if the function of 360 pivot is correct!

